

20906

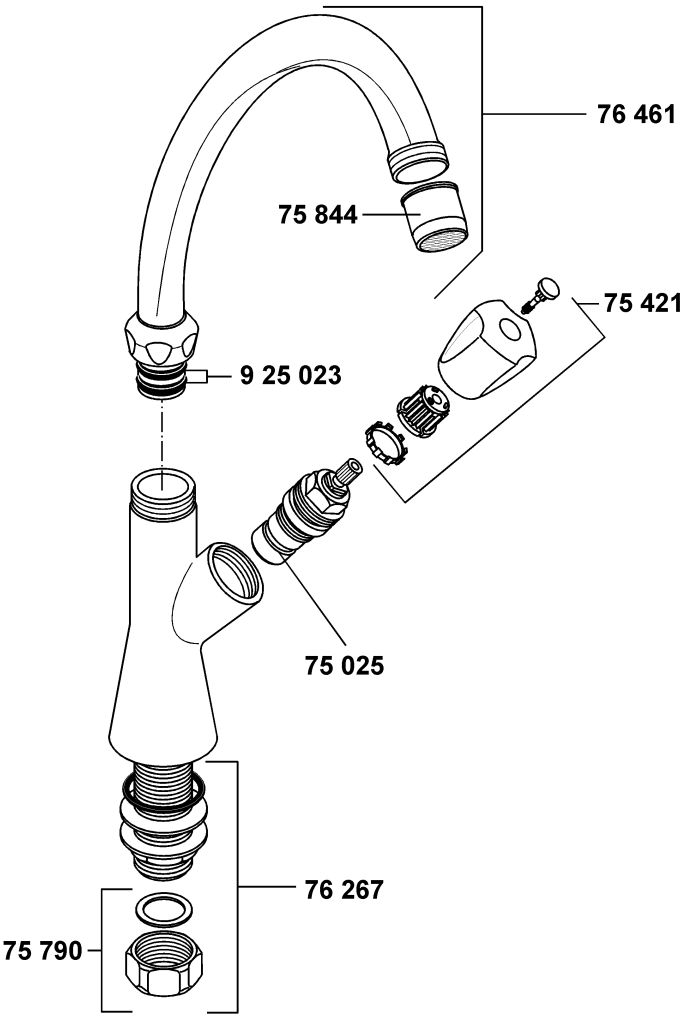

A_2090608

20906	Standventil 1/2	stand pillar tap 1/2	toiletkraan 1/2
	75 025 Keramik-Oberteil G 1/2, 180°	ceramic headpart G 1/2, 180°	keramisch bovendeel G 1/2, 180°
	75 421 Griff, Metall	handle, metal	greep, metaal
	75 790 ÜW-Mutter	nut	wartelmoer
	75 844 Luftsprudler M 22 x 1/2	mousseur M 22 x 1/2	perlator M 22 x 1/2
	76 267 Befestigungssatz	assembling set	bevestigingsset
	76 461 HU-Auslauf 130 mm	HU-spout 130 mm	HU-uitloop 130 mm
	925 023 O-Ring	O-ring	o-ring